

Instruction Manual DMA-355H

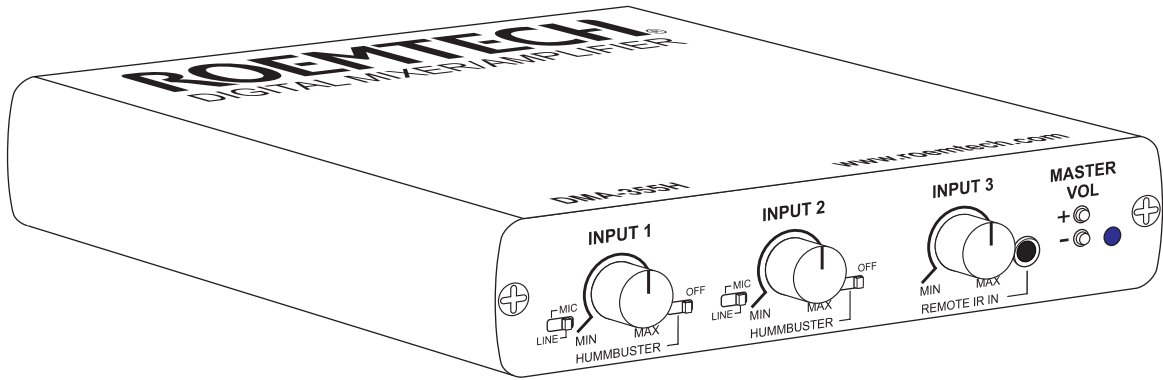

www.roemtech.com

List of Contents

1. Digital Mixer Amplifier
Stereo/Mono - 55 Watts

2. Regulated 60 Watt Power
Supply & 5' Power Cord

3. Amplifier Mount, Mounting
Screws & Washers

4. Speaker Terminal Block

5. Universal Dual Band IR Receiver

6. IR Remote Control

7. Phillips Mounting Screws

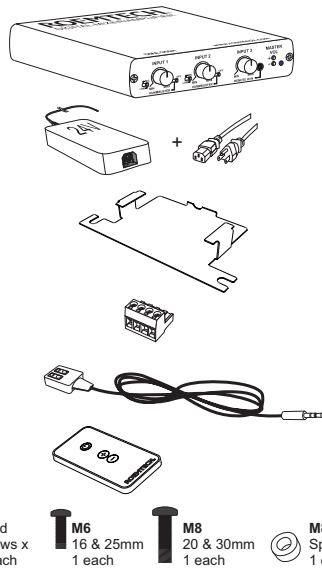

Wood
Screws x
2 each

M6
16 & 25mm
1 each

M8
20 & 30mm
1 each

M8
Spacer
1 each

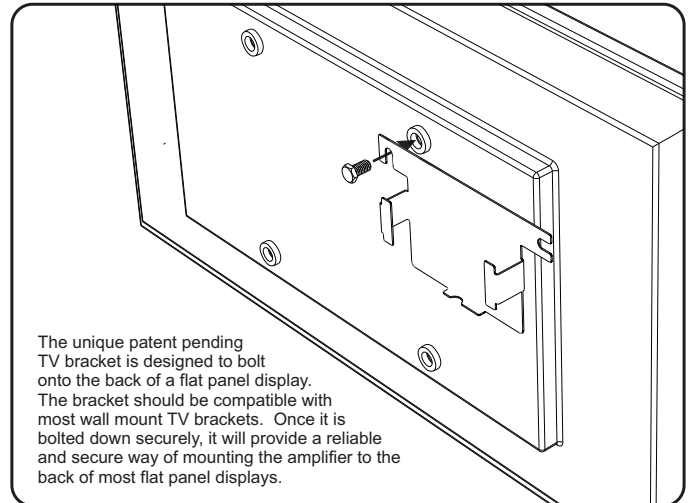

The unique patent pending TV bracket is designed to bolt onto the back of a flat panel display. The bracket should be compatible with most wall mount TV brackets. Once it is bolted down securely, it will provide a reliable and secure way of mounting the amplifier to the back of most flat panel displays.

For Technical
Assistance Call
972-221-3030

Features

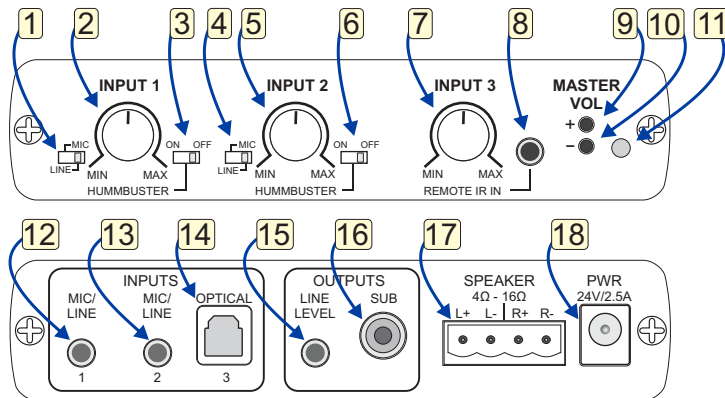

Hidden Features

IR Programming **VOLUME UP** Step 1 - Hold down the Master Vol **+** and **-** simultaneously until the LED turns **yellow**. Step 2 - While the LED is **yellow**, push the + button once, (LED will flash **green** once every 2 seconds). Step 3 - Push the “volume up” button on the remote, LED will flash **green twice** to confirm, then back to solid **blue**. If LED flashes **red twice**, the command has not been accepted. *Note - the included Roemtech remote will always be recognized by the amplifier.*

VOLUME DOWN Repeat Step 1. Step 2 - While the LED is **yellow**, push the - button once, (LED will flash **green** twice every 2 seconds). Step 3 - Push the “volume down” button on the remote, LED will flash **green three times** to confirm, then back to solid **blue**. If LED flashes **red three times**, the command has not been accepted.

MUTE Repeat Step 1. Step 2 - While the LED is **yellow**, push both buttons once again briefly, (LED will flash **green** three times every 2 seconds). Step 3 - Push the “mute” button on the remote, LED will flash **green four times** to confirm, then back to solid **blue**. If LED flashes **red four times**, the command has not been accepted.

Mono/Stereo **STEREO** *Note: The amplifier is configured in a stereo mode from the factory. This step will only be necessary if the amp has been switched to Mono and you wish to set it back to Stereo.* Step 1 - Make sure the amplifier is unplugged. Hold down the Master Vol **+** button. Step 2 - While still holding down the Master Vol + button, plug in the power cord. The LED will flash **green four times** indicating the amplifier is set to stereo.

MONO Step 1 - Make sure the amplifier is unplugged. Hold down the Master Vol **-** button. Step 2 - While still holding down the Master Vol - button, plug in the power cord. The LED will flash **yellow four times** indicating the amplifier is set to stereo.

EQ Settings There are five EQ settings, four are preset and the fifth is customizable via the “Input Volume” knobs **2** (lows), **5** (mids), **7** (highs). **To access the EQ mode**, hold the Master Vol **+** and **10**- buttons simultaneously until the light turns **pink**. Tapping the + or - buttons individually will scroll through the different EQ modes. EQ 1 is flat (LED flashes **pink once** every 2 seconds). EQ 2 is a bass boost (LED flashes **pink twice** every 2 seconds). EQ 3 is a bass and treble boost (LED flashes **pink three** times every 2 seconds). EQ 4 is a treble boost (LED flashes **pink four** times every 2 seconds). EQ 5 is customizable (LED flashes **pink and blue alternately**). In this setting you can use the three volume knobs to adjust the tone. Note: Top dead center for each knob indicates flat EQ setting. Once you have the desired EQ setting push and release the + and - buttons simultaneously, the LED will flash **pink** indicating that the EQ is now set. The volume of each input will slowly adjust to the last position of the volume knobs.

Input 1 Override/Passthrough Input one can be set to override inputs 2 and 3 while passing through its’ own audio. Simply hold the Master Vol **+** and **10**- buttons down simultaneously while moving the “Mic/Line” **1** switch from “Line” to “Mic” and then back to “Line” immediately. Without letting off the volume +/- buttons, turn the “Input 1” **2** knob slowly from the “Min” to the “Max” position until the LED turns from **white to red**, this will set the sensitivity for the override signal. To cancel this feature, repeat the above process although you will not need to turn the “Input 1” knob. *This feature only works with line level signals.* The LED will continue to blink **white** during an override event.

Features Explained

- 1 **Mic/Line:** Switches Input 1 to either balanced mic or unbalanced line level. Also used for hidden features, see “Hidden Features” section for more information.
- 2 **Input 1:** Volume control for Input 1. Also used for hidden features, see “Hidden Features” section for more information.
- 3 **HummBuster:** Switches HummBuster® on or off for Input 1.
- 4 **Mic/Line:** Switches Input 2 to either balanced mic or unbalanced line level.
- 5 **Input 2:** Volume control for Input 2. Also used for hidden features, see “Hidden Features” section for more information.
- 6 **HummBuster:** Switches HummBuster® on or off for Input 2.
- 7 **Input 3:** Volume control for input 3. Also used for hidden features, see “Hidden Features” section for more information.
- 8 **Remote In:** 3.5mm jack for IR pickup for 3.3V sensor.
- 9 **Master Vol +:** Pushbutton for increasing master volume. Also used for hidden features, see “Hidden Features” section for more information.
- 10 **Master Vol -:** Pushbutton for decreasing master volume. Also used for hidden features, see “Hidden Features” section for more information.
- 11 **LED:** RGB LED indicates blue for good power. Emits multiple colors for mode setting and other functions. Also used for hidden features, see “Hidden Features” section for more information.
- 12 **Input 1 Jack:** Accepts either mic or line level inputs via 3.5mm, 3 conductor plug. In “Line Level” mode only, can also be set as a priority override.
- 13 **Input 2 Jack:** Accepts either mic or line level inputs via 3.5mm, 3 conductor plug.
- 14 **Input 3 Jack:** Accepts standard optical/Toslink input. Mixes with analog inputs.
- 15 **Line Level Output:** Outputs line level, 3.5mm, stereo, post mix, pre EQ audio.
- 16 **Sub Output:** Outputs line level, RCA, mono, post mix, pre EQ audio, 20Hz-20kHz. Can also be used for a mono line level out for general audio.
- 17 **Speaker:** Speaker level out. Mono or Stereo, see “Hidden Features” section.
- 18 **Power:** Takes 24V, 2.5A DC, center pin is +.

Important Note: *The optical input on this amplifier will not recognize “non PCM” audio.* This includes proprietary compression formats such as Dolby®, THX® and others. The device that is connected to this amplifier ***must be set to PCM audio out only for optical audio.***